

# NSW Foundation Spatial Data Framework Data Custodian Records



The following spatial theme profile is the formal custodian arrangements for whole of government foundation spatial data.

## Geocoded Addressing theme

### Theme profile

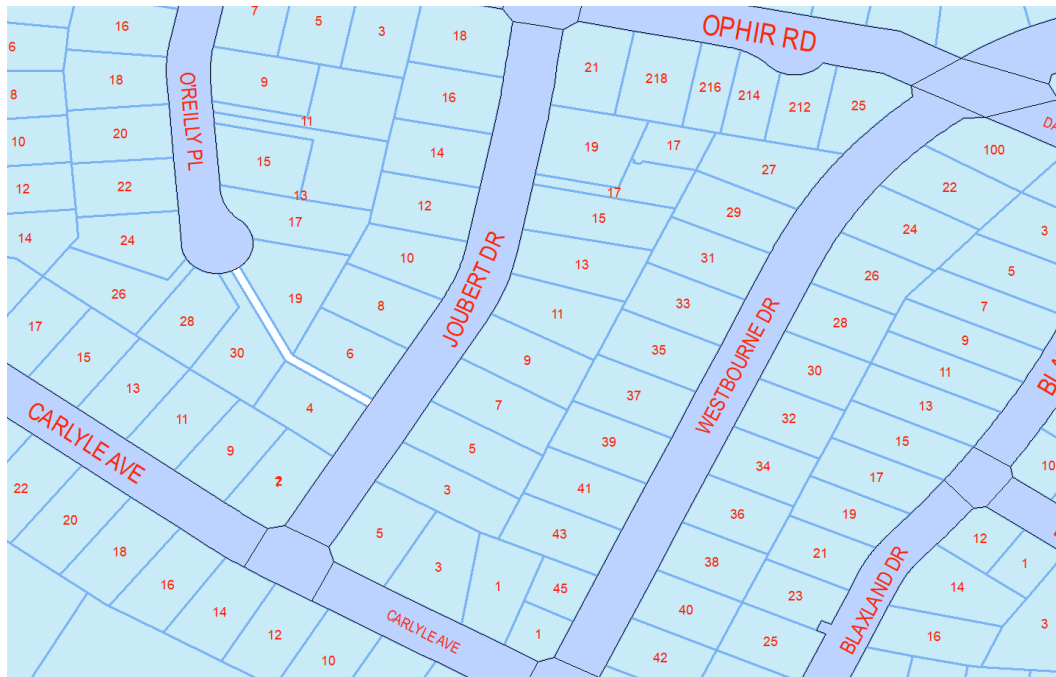

Image depicts a sample of house numbers overlaid on a cadastral dataset  
© DFSI Spatial Services 2018

<b>Name</b>	Geocoded Addressing
<b>Description</b>	Addressing is the specific identification of a fixed location (for example, a plot of land, building, part of a building, way of access or other construction) which is represented by a structured arrangement of place names. It may be further detailed with the inclusion of other valuable attributes including geocodes.
<b>Datasets</b>	Address Point

<b>Purpose</b>	<p>Addressing data provides users with unique and clear identification of a plot of land that allows the user to find and access the property for a variety of purposes.</p> <p>Addressing is used for:</p> <ul style="list-style-type: none"> <li>• communication</li> <li>• address validation</li> <li>• public safety</li> <li>• delivery of products and services</li> <li>• socio-economic and demographic analysis.</li> </ul>
<b>Status</b>	<p>The NSW Addressing database is the authoritative property addressing system for NSW. This database was initially populated with address information sourced from the PSMA's Geocoded National Address File (GNAF) and continuously updated through automated batching processes of property and address information sourced from Property NSW (Valnet database), spatially structured components sourced from the Digital Cadastral Database (legal boundaries) and Digital Topographic Database (road names and extents), Councils, Geographical Names Board and Transport for NSW.</p> <p>The NSW Addressing database provides incremental address updates to PSMA to maintain GNAF's currency on behalf of NSW.</p>
<b>Standards</b>	<p>Metadata for the relevant Spatial Services datasets are required to comply with AS/NZS ISO 19115-2 ANZLIC Metadata Profile v1.1 and ISO 19139.</p> <p>The Address information is required to conform to the NSW Addressing User Manual. This document is available at:</p> <p><a href="http://www.gnb.nsw.gov.au/__data/assets/pdf_file/0007/199411/2018_NSW_Addresssing_User_Manual.pdf">http://www.gnb.nsw.gov.au/__data/assets/pdf_file/0007/199411/2018_NSW_Addresssing_User_Manual.pdf</a></p>
<b>Version</b>	<p>Version 0.7</p>